

## FNC PR22 Absolute Series



### Features

- MEMS technology
- Small & compact housing
- Stainless steel housing
- Ratiometric analog output
- Large temperature
- Absolute and gauge measuring
- High accuracy absolute pressure sensor

### Technical data- Electrical Ratings

<b>Measurement Range</b>	0.1...5.5 Bar
<b>Electrical Output</b>	4-20 mA, 0.4-9.8V Out 0.4-9.6V Out (Absolute)
<b>Electrical Connection</b>	1 meter cable
<b>Precision</b>	%1

### Technical data- Mechanical Ratings

<b>Mechanical Connection</b>	M12X1,5
<b>Housing</b>	Stainless Steel
<b>Operating Temperature</b>	-40°C ... +150°C

**FNC PR22 Absolute Series**

**Mechanical Dimensions**

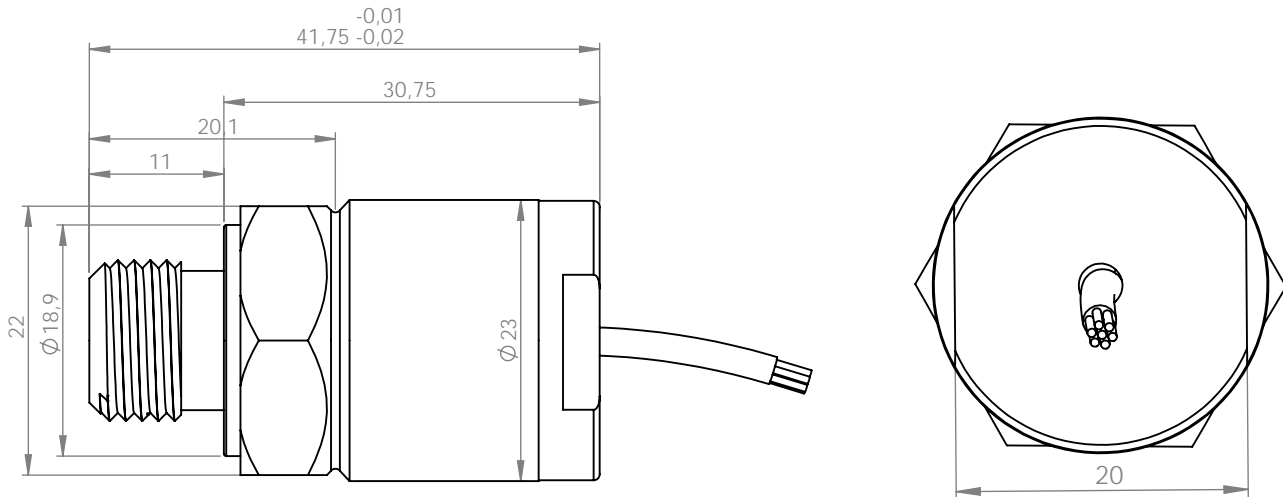

**Mechanical Connection**

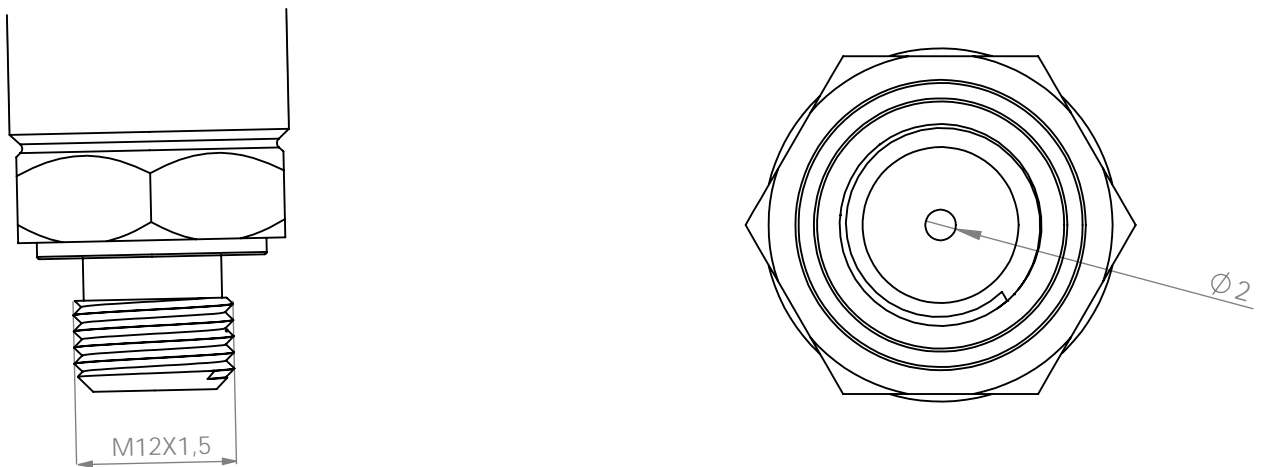

# Pressure sensor

## Cable Wiring, Part Numer

## FNC PR22 Absolute Series

### 0.4-9.6V Connection

Function	Color	Renk
+12...30 VDC	Red	Kırmızı
GND	Black	Siyah
Output	Yellow	Sarı

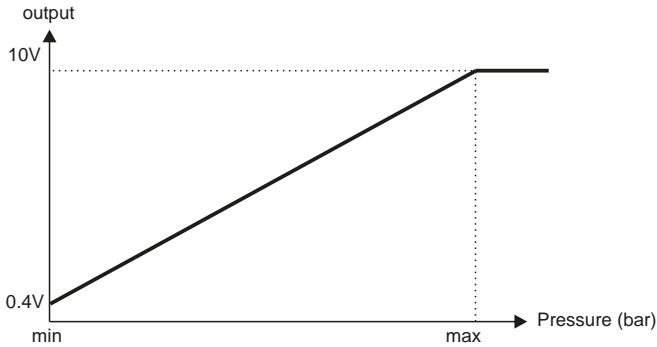
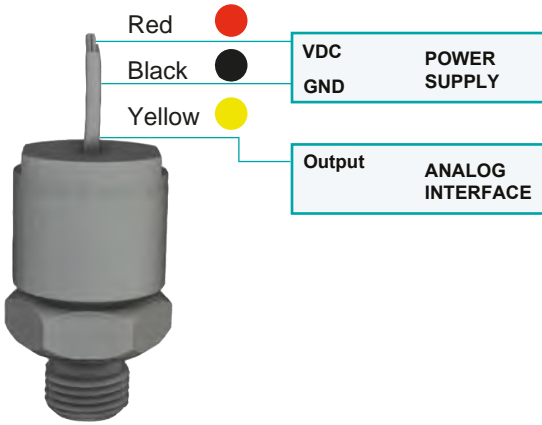

### 4-20mA Connection

Function	Color	Renk
+12...30 VDC	Red	Kırmızı
GND	Black	Siyah
Output	Yellow	Sarı

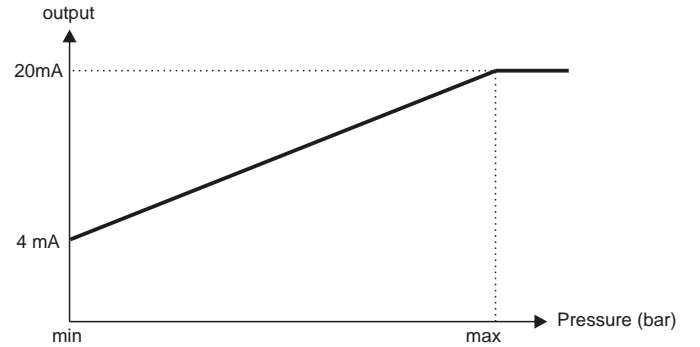
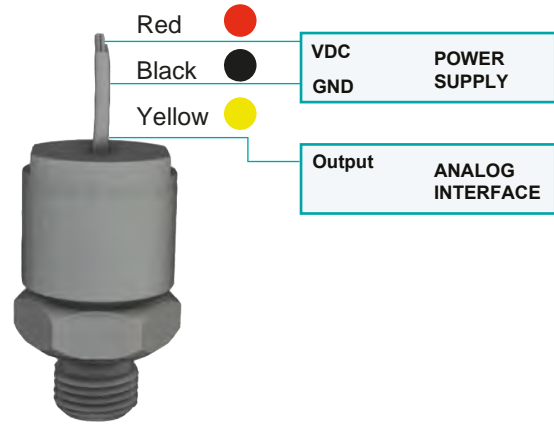

### Part Number

FNC PR A 22 0225 V

A : Absolute

V : Voltage Out

#### Pressure range

0111 : 0,1 - 1,15 Bar (Voltage range: 0,8V-9,3V)  
01312 : 0,133 - 1,119 Bar (Voltage range: 2V-8,4V)  
0225 : 0,2 - 2,5 Bar (Voltage range: 0,4V-9,6V)  
0230 : 0,2 - 3,0 Bar (Voltage range: 0,8V-9,3V)  
0240 : 0,2 - 4,0 Bar (Voltage range: 0,4V-9,6V)  
0255 : 0,2 - 5,5 Bar (Voltage range: 1V-9V)  
0540 : 0,5 - 4,0 Bar (Voltage range: 1V-9V)